



Description:

SURE Sanitary Turbine Flow Meter provides the high accuracy and rigorous design in a sanitary-style tri-clamp mounting configuration. Developed for use in a variety of food, beverage and pharmaceutical applications, the Sanitary Turbine is suitable for use in clean-out-of-place(COP) environments. The meter features as SS304 or Ss316 body and internal wet parts, with CD4MCu stainless steel turbine and tungsten carbide rotor shaft.

E 930/24.15 Specifications are subject to change without prior notice

Special Features:

- Pressure resistant to 10 bar
- Viscosity of 1 to 10 cst
- Output signal: Pulse or 4-20 mA
- Communication: RS485/HART
- Connection: Sanitary Tri-Clamp

Need help?

www.suremeter.com
overseas@suremeter.com

Sanitary Turbine Flow Meter

LWS Series For Sanitary Application

Technical Specifications:

Flow Range

Diameter (mm)	Standard Range (m ³ /h)	Extended Range (m ³ /h)
4	0.04 - 0.25	0.04 - 0.4
6	0.1 - 0.6	0.06 - 0.6
10	0.2 - 1.2	0.15 - 1.5
15	0.6 - 6	0.4 - 8
20	0.8 - 8	0.45 - 9
25	1-10	0.5 - 10
32	1.5 - 15	0.8 - 15
40	2-20	1-20
50	4 - 40	2 - 40
65	7 - 70	4 - 70
80	10 - 100	5 - 100
100	20 - 200	10 - 200

Output (Depending on Converter Model)	
	Pulse
	4...20mA
Accuracy	1.0% of Rate / 0.5% of Rate
Ambient Conditions	
Operating Temperature	-20...+60 °C
Fluid Temperature	-20...+130 °C
Material	
Housing	SS304 / SS316
Rotor	CD4MCu
Bearing	Tungsten carbide

Model Selection:

LWS XXX X -XX X X X -TRC

Diameter
 XXX: 3 digits; For example:
 004: 4mm; 015: 15mm; 025: 25mm
 100: 100mm; 125: 125mm; 200: 200mm

Converter Type
 N1: Pulse; without display
 N2: Pulse; with display; Ex
 A: 4-20 mA; with display; Ex
 B: Battery Power; LED Display; Ex; No Output
 C1: 24V DC; Pulse + 485
 C2: 24V DC; 2-wire 4-20mA; Pulse + RS485
 C3: 24V DC; 3-wire 4-20mA; Pulse + RS485
 H: 24V DC Supply; 4-20mA/HART; LED Display; Ex

Accuracy
 10: 1.0% of Rate
 05: 0.5% of Rate
 02: 0.2% of Rate

Flow Range
 S: Standard Range
 E: Extended Range

Housing Material
 S: SS304
 L: SS316

Explosion Proof
 E: Exd II BT6
 N: Without Ex Proof

Connection
 TRC: Tri-clamp for Sanitary Application

Dimension



a	DN4-DN40	1mm
	DN50-DN80	1.5mm
	DN100	2mm

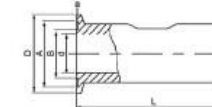

Diameter	D(mm)	A(mm)	B(mm)	d (mm)	L(mm)
DN4				4	
DN6				6	
DN10				10	
DN15	50.5	46	40.5	15	100
DN20				20	
DN25				25	
DN32				32	
DN40	64	59	54	40	140
DN50	77	73.5	68.5	50	150
DN65	91	86	88.5	65	170
DN80	106	100.5	94	80	200
DN100	119	113	106	100	220

Product Photo:



LWS-N2



LWS-C

Need help?

www.suremeter.com
overseas@suremeter.com

Taniya Infratech Co., Ltd.
 965/234 Rangsit-Nakornnayok Rd., Prachathipat, Thunyaburi, Pathumthani 12130
 Tel : 02-5498009 Fax : 02-5498010
www.taniyainfratech.com, www.thaiflowmeter.com Email : info@taniyainfratech.com